

CITY OF MURRAY CONTROL MONUMENT CARD

DESIGNATION: G5 2010 A
TYPE: 30" POURED CONCRETE MONUMENT W/ CITY DISK
DATE SET: JUNE 2010 QUAD: NEW CONCORD, KY.
HORIZONTAL DATUM: NAD-83 (NSRS 2007)
VERTICAL DATUM: NAVD-88 (GPS) ZONE: KY. S 1602

NORTHING: 1756112.635 FT STATE: KENTUCKY
EASTING: 910281.280 FT COUNTY: CALLOWAY
ELEVATION: 533.16 FT (GPS)
LATITUDE: N 36°37'28.89387" LONGITUDE: W 088°14'17.68259"
SCALE: 1.000021495 CONVERGENCE: -1°30'32.49731"
PLANE AZI. TO AZI. MARK:

To Reach: Located at the intersection of Post Oak Dr.
and Pottertown Rd.

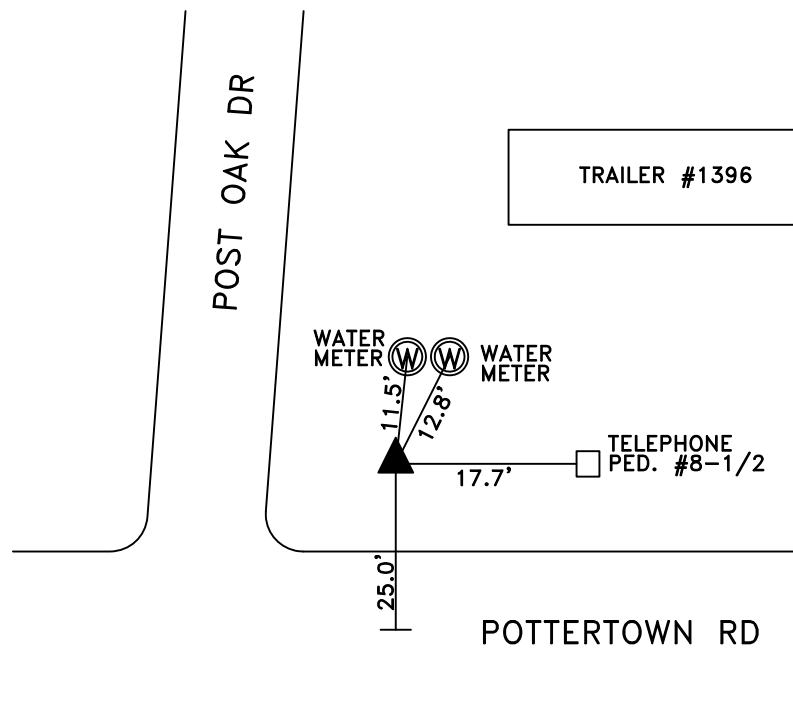

NOT TO SCALE



GRW Aerial Surveys, Inc.
801 Corporate Dr. Lexington Ky. 40503
(859)223-3999